

ISAMU noguchi

1904-1988



Isamu Noguchi was born in Los Angeles, California, to an American mother and a Japanese father. He is one of the twentieth century's most important and critically acclaimed sculptors. Through a lifetime of artistic experimentation, he created sculpture, gardens, furniture and lighting designs, paintings, ceramics, architecture, and set designs. His work, at once subtle and bold, traditional and modern, set a new standard for artistic achievement.

Noguchi, traveled extensively throughout his life. He discovered the impact of large-scale public works in Mexico, earthy ceramics and tranquil gardens in Japan, subtle ink-brush techniques in China, and the purity of marble in Italy. He incorporated all of these inspirations into his work, which utilized a wide range of materials, including stainless steel, marble, cast iron, balsawood, bronze, sheet aluminum, basalt, granite, and even water. Noguchi's public works are worldwide, ranging from playgrounds to plazas, to gardens to fountains, and reflecting his belief in the social role of sculpture.

PACIFIC ARTS PLAZA

Located in the center of Orange County's business, culture and entertainment district; Pacific Arts Plaza is comprised of four Class-A office buildings that sit within a beautifully decorated 1.6 acre outdoor plaza, featuring The California Scenario sculpture garden. The property stands as the gateway into South Coast's Theater and Arts District and is within walking distance to dining, premier shopping and hotels.

IRVINE COMPANY OFFICE PROPERTIES

With a commitment to long-term ownership and a passion for quality, Irvine Company Office Properties offers customers an unparalleled experience. The result: A strong sense of pride in your place of business, fully supported by a level of service unsurpassed in the industry. All this, plus the opportunity to move and expand within our diverse portfolio, are just a few of the reasons to lease with Irvine Company Office Properties.



IrvineCompanyOffice.com



California Scenario

NOGUCHI SCULPTURE GARDEN

California Scenario

INTRODUCED IN 1980

Isamu Noguchi was commissioned to design a 1.6 acre public garden to enhance two office towers built on family land once used as a lima bean farm. The California Scenario is an abstract metaphor of California's diverse natural environment and is considered to be one of Noguchi's significant contributions to Landscape Architecture.

The garden begins at the thirty-foot-high sandstone triangle named "Water Source", travels through a stream filled with water and stones, and ends at "Water Use", a granite wedge. "Forest Walk" takes visitors past a patch of California redwoods while "Land Use" is an eight-foot-high knoll, topped with a simple form of Sierra white granite. "Desert Land" features a symmetric mound with desert plants. The sculpture "Spirit of the Lima Bean", is composed of twelve-foot-high carved granite boulders, educating visitors about the earlier use of the site. The "Energy Fountain", is twenty five-feet in diameter and made from granite bricks and stainless steel.



The Garden



Energy Fountain

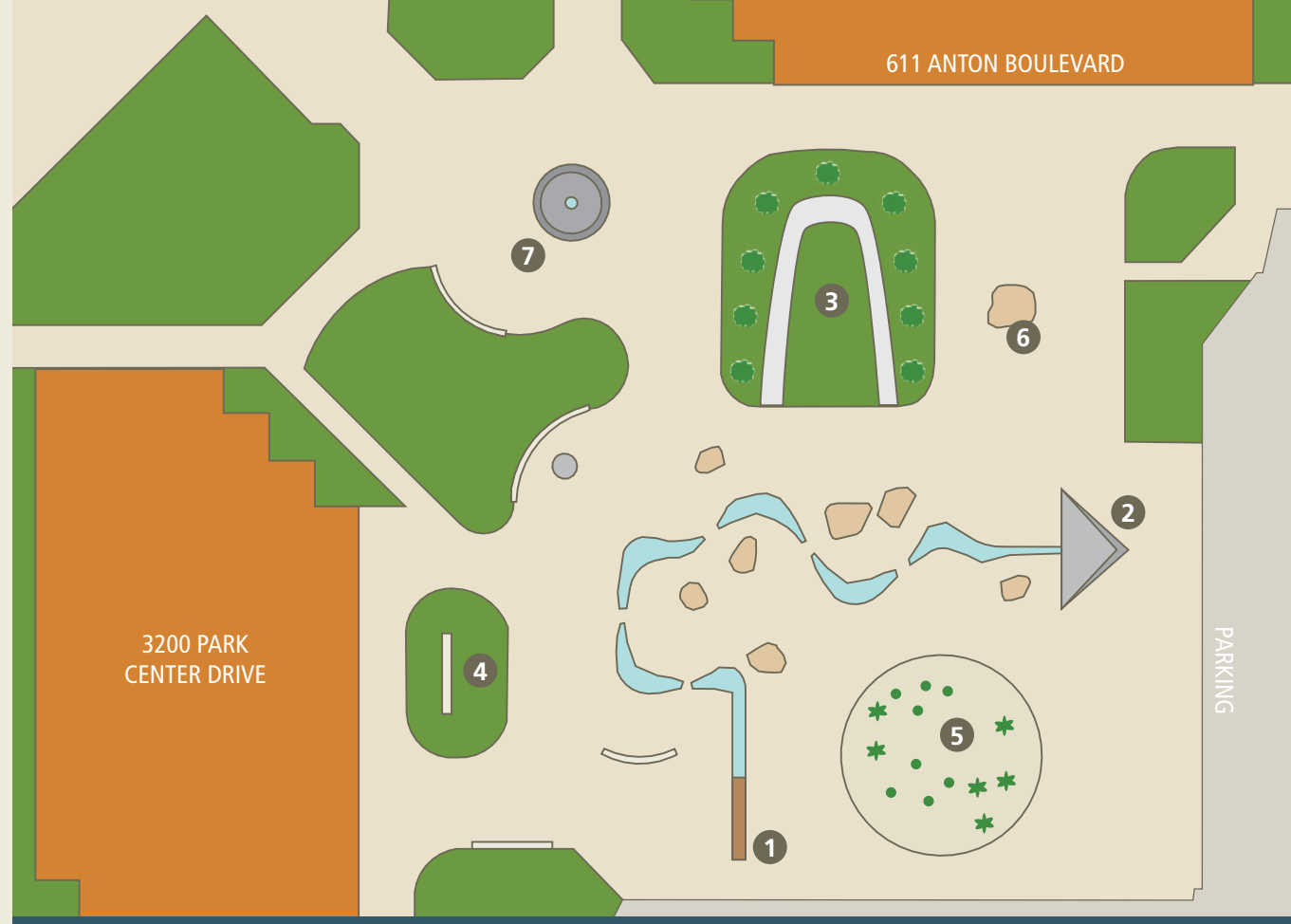

1 WATER SOURCE

A thirty-foot high sandstone triangle functions as the beginning of the stream.

2 WATER USE

A granite wedge symbolizing the end of the California Scenario stream.

3 FOREST WALK

Visitors pass a patch of California redwoods to evoke one of California's salient characteristics.

4 LAND USE

Consisting of an eight-foot high knoll, topped with a simple form of Sierra white granite.

5 DESERT LAND

Symmetrical mound planted with a variety of cacti, agave and other desert plants.

6 SPIRIT OF THE LIMA BEAN

Twelve-foot high granite boulders, indicative of the land, once used as a Lima Bean farm.

7 ENERGY FOUNTAIN

Embodies California energy. The fountain is twelve-foot high and twenty five feet in diameter, while made of granite bricks and stainless steel.