



*Recently Revitalized*

**Irvine Spectrum  
Orange County**

**15205-15295  
Alton Parkway, Irvine**

**Office/R&D  
Workplace Community**



/ Work Smart. Live Well.® /



Providing the ultimate address for forward-thinking businesses, the office/R&D workplace community of Alton Plaza supports growth and innovation for companies who come to Irvine to be part of this major tech hub.

## World Class Features & Amenities

- Richly landscaped **19-building office/R&D campus** offering **219,000 sq. ft.**
- **Suites** ranging from **4,000 - 20,000 sq. ft.** and **warehouse heights** of **13 - 24 ft**
- Conveniently abundant **surface parking** (3.3:1,000) and **3 EV charging stations**
- **Building signage opportunities** elevate your brand with exposure to the prominent interaction of **Alton & Technologies**
- New **outdoor workspaces** for meeting, collaborating and socializing that bring the best of coastal California to the workplace
- Access **250+ top restaurants** and **specialty retail stores** at **Irvine Spectrum Center®**, **Sand Canyon Plaza**, **Oak Creek Shopping Center** and **Los Olivos Specialty Center**
- Host out-of-town guests at the nearby **Courtyard by Marriott** featuring a **5,000 sq. ft. conference room**
- Enjoy **resort style living** at **The Village, The Park, Centerpoint, Westview, or Los Olivos apartments**
- Easy access to the **5, 405 and 133 Freeways** and the **241 Toll Road**
- **Simplify commuting** with the **Irvine Station** transportation hub, connecting Irvine Spectrum with Metrolink commuter and Amtrak



/ Exceptional Today. Even Better Tomorrow.® /

Reinvestment Completed Summer 2018



## Hardscape & Landscape

From renovated concrete pavement to additional living walls and drought-resistant grass, refreshed finishes provide an energized, contemporary workplace experience for employees and guests.

## Building Exterior

Entry advancements include newly painted accent walls with distinct color-coded identification among the three “neighborhoods,” with floor-to-ceiling glass entries for an open atmosphere, and customer roll-up doors for efficient accessibility.

## Outdoor Workspaces

Outdoor workspaces with lounge and cafe seating featuring large shade structures and complimentary WiFi as well as built in BBQ stations create an ideal space to connect, refresh and collaborate.

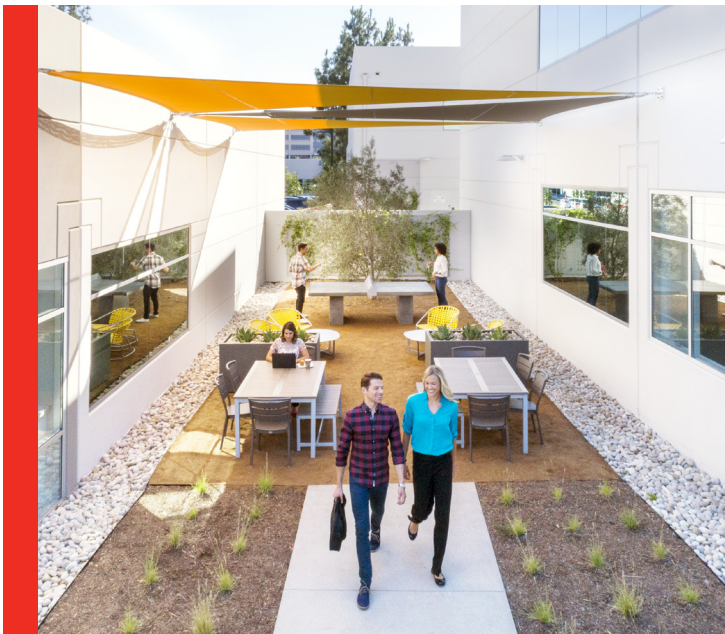

# Alton Plaza

15205-15295 Alton Parkway, Irvine

Orange County  
Irvine Spectrum

## / Site Map /



## / Area Map /

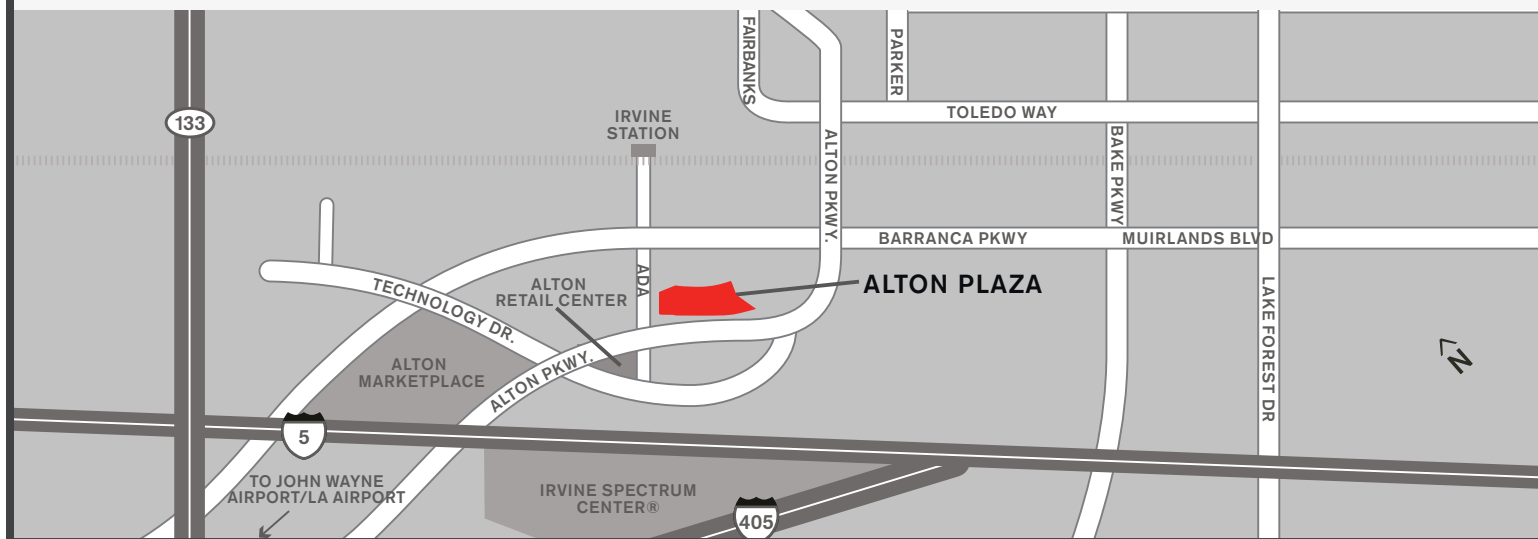

Our mission is to provide you with **Vibrant Workplace Communities®**, where our unrivaled collection of properties, dynamic teams and memorable experiences will uniquely position you and your team to achieve unprecedented levels of success.



For Leasing Information

Call: Sue Lyle or Gabriella Cera | 949.720.2762

[IrvineCompanyOffice.com](http://IrvineCompanyOffice.com)