



2445 - 2795 AUGUSTINE DR.  
SANTA CLARA, CALIFORNIA

# SANTA CLARA SQUARE® OFFICES





OVERVIEW



## THE FUTURE OF BUSINESS LIVES HERE

Santa Clara Square is the bold move your team deserves — a lifestyle-enhancing workplace with a smart collection of on-site and next-door amenities that drive productivity.

// SANTA CLARA SQUARE

All properties are offered for lease through Irvine Management Company, a licensed real estate broker DRE LIC. #02041810



OVERVIEW

# BE WHERE BUSINESS THRIVES

With their innovative design, the one eight-story and seven six-story buildings at Santa Clara Square offer 1.7M SF of sleek, modern workspace to accommodate your company's growth and success.

### DESTINATION-WORTHY AMENITIES

Indoor and outdoor gathering spaces that bring the best of coastal California to the workplace with unique opportunities for socializing, meeting and collaborating.

### THE ULTIMATE LIVE, WORK, PLAY LIFESTYLE

Put your team across the street from exceptional dining, shopping and resort-style living for an all-in-one lifestyle that supports flexible work.

### A WORKPLACE WELLNESS MOVEMENT

Teams energize body and mind with two comprehensive Kinetic Fitness centers, sports courts and direct access to trails for hiking and biking.

### CERTIFICATIONS



// SANTA CLARA SQUARE

All properties are offered for lease through Irvine Management Company, a licensed real estate broker DRE LIC. #02041810

## FEATURES

# CONNECT & COLLABORATE

Bring out the best in your team with seamless indoor-outdoor connectivity and engaging amenities that elevate the workday.



Eight mid-rises, 1.7M SF



Express Eats featuring Eat Club and The Kitchen



Two Kinetic Fitness centers with studio rooms and sports courts



The Commons outdoor workspace



Two Venue Meetings & Events spaces



Santa Clara Square Marketplace and Apartment Homes

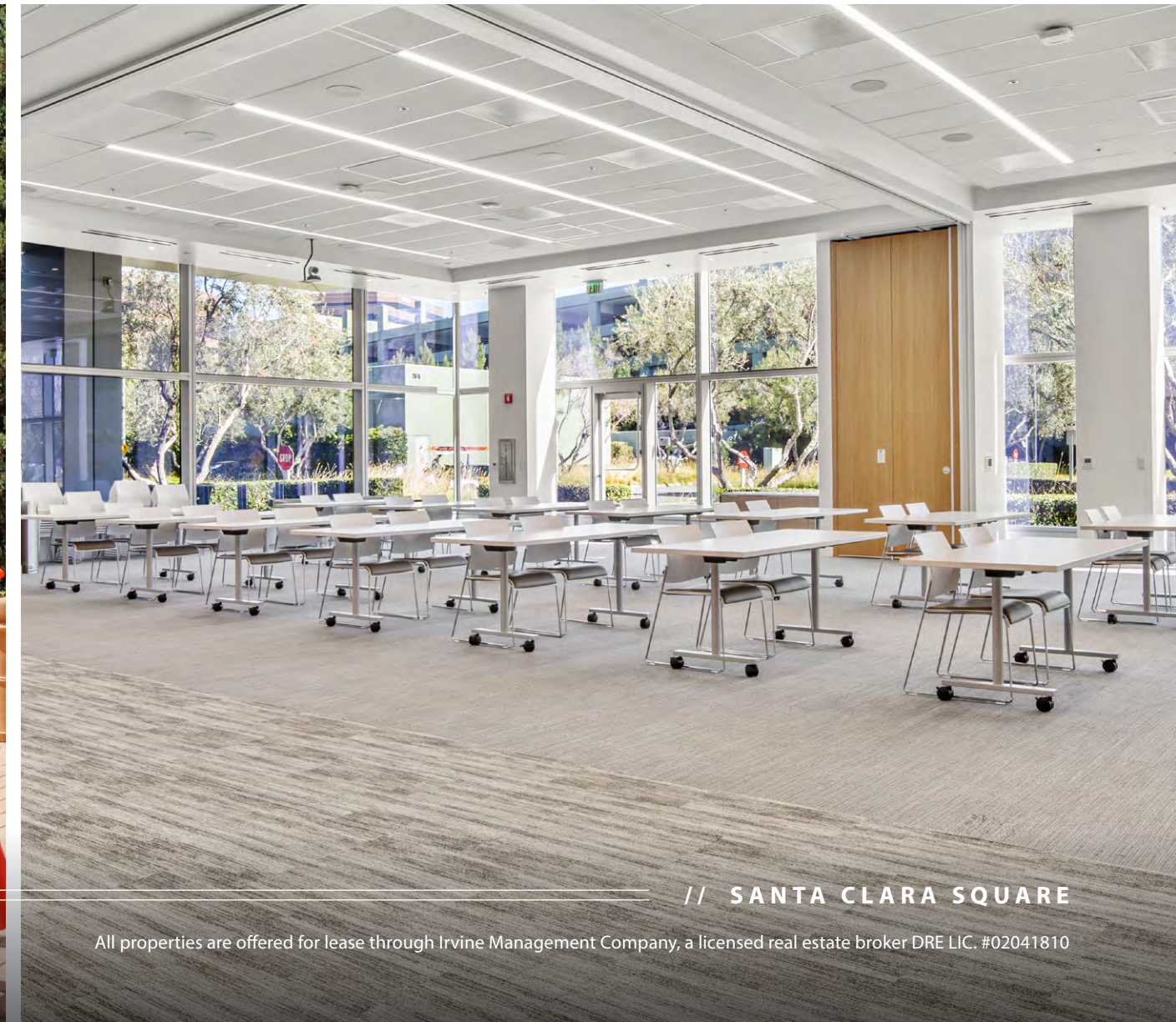

// SANTA CLARA SQUARE

All properties are offered for lease through Irvine Management Company, a licensed real estate broker DRE LIC. #02041810



LOCATION

# SANTA CLARA SQUARE OFFICES AREA MAP

Simplify commutes with direct access to the Highway 101 ramp, 237, 85 and 880, a 10-minute Caltrain shuttle ride from Mountain View and Lawrence Caltrain Stations, and just minutes to Amtrak and San Jose International Airport.



847

APARTMENT  
COMMUNITIES



405

ENTERTAINMENT  
VENUES



150

FITNESS  
CENTERS



160

HOTELS



1,542

RESTAURANTS



2,143

RETAIL SHOPS

WITHIN A 5-MILE RADIUS

// SANTA CLARA SQUARE

All properties are offered for lease through Irvine Management Company, a licensed real estate broker DRE LIC. #02041810



# Move-in Ready *Workspaces*

Flex+ offers small businesses premium, move-in ready suites in the best locations — plus no upfront investment or long-term commitment.



## premium workspace

Build your brand in expertly designed suites with high-end finishes and furniture options.



## move-in ready

Save on startup costs with no upfront investment, build-outs or long lead times.



## flexible lease terms

Choose terms that work for you with no long-term commitment and scale across our 150+ workplaces.



## personalized support

Make everything easier with simplified leasing and attentive customer care every step of the way.

GET STARTED AT [FLEXPLUS.COM](https://flexplus.com)



// SANTA CLARA SQUARE

# WE CREATE PLACES THAT BRING PEOPLE TOGETHER TO SUCCEED

More than 18 million people choose to live, work, shop, stay and play in Irvine Company's 129 million SF real estate portfolio. Decades of thoughtful planning and stewardship ensure we deliver exceptional placemaking and customer experiences — all backed by our commitment to long-term ownership and industry-leading financial stability.

## INDUSTRY-LEADING FINANCIAL STABILITY

Our unmatched capital resources ensure we uphold our standards of excellence, regardless of market conditions.

## FUTURE-PROOF FLEXIBILITY

A range of lease options and our collaborative partnership support your growth.

## ELEVATED CUSTOMER CARE

Expert teams, fast response times and personalized service ensure worry-free workdays.

## READY FOR WHAT'S NEXT

From enabling hybrid solutions to supporting diverse work styles, we keep your business at the forefront of what's possible.

## ACTIVATED TO ATTRACT & ENGAGE TEAMS

Experience-driven amenities make your workplace an essential employee destination.

## SUSTAINABILITY BY DESIGN

We strive to lead and innovate for the preservation of environmental resources.





**OWNED AND MANAGED BY**

---



**TODD HEDRICK**  
**REGIONAL VICE PRESIDENT**  
thedrick@irvinecompany.com  
408.330.0126  
CA LIC. 01152266

**IRVINECOMPANYOFFICE.COM**

**FOR LEASING**

---



**MARK SCHMIDT**  
**VICE CHAIRMAN**  
mark.schmidt@cbre.com  
408.460.5295  
CA LIC. 00872826

**CHRISTIAN MARENT**  
**EXECUTIVE VICE PRESIDENT**  
christian.marent@cbre.com  
408.453.7422  
CA LIC. 00932744

**WILL SCHMIDT**  
**FIRST VICE PRESIDENT**  
will.schmidt@cbre.com  
408.453.7408  
CA LIC. 07988485

All properties are offered for lease through Irvine Management Company, a licensed real estate broker DRE LIC. #02041810. ©2025 CBRE, Inc. and Irvine Management Company. All rights reserved. This information has been obtained from sources believed reliable, but CBRE and Irvine Management Company make no representation or warranty as to the accuracy or completeness of such data and it should be independently verified by prospective tenants. You should conduct a careful, independent investigation of the property and verify all information. Any reliance on this information is solely at your own risk. All renderings, floor plans, pictures shown are for information and illustration purposes only and are subject to change. Images may not be to scale. May not show final material and finishes. Products, features, and amenities subject to availability. CBRE and the CBRE logo are service marks of CBRE, Inc. All other marks displayed on this document are the property of their respective owners, and the use of such logos does not imply any affiliation with or endorsement of CBRE. Photos herein are the property of their respective owners. Use of these images without the express written consent of the owner is prohibited. The Sunwave, Santa Clara Square, Flex+ and Irvine Company are registered trademarks of Irvine Management Company.