



330 Potrero Avenue

SUNNYVALE, CA

±35,654 SF (Divisible to ±10,000 SF)

 IRVINE COMPANY | **CBRE**

Workplace Highlights

WORKSPACE

- ±35,654 SF (Divisible to ±10,000 SF)

NEW MARKET READY WORKSPACE

- Excellent signage and identity opportunity
- New 10' floor-to-ceiling storefront glass and entry feature
- Large 24K SF open floor plan with high-end improvements
- Large 12K SF production/assembly/lab area
- New restroom cores with showers
- Title 24 compliant

NEW OUTDOOR AREA

- New outdoor dining and collaboration space
- New landscaping throughout
- Nine (9) EV charging stations

HVAC SERVICE

- Multiple units, 138 tons of capacity

LOADING

- Two (2) ground-level loading doors

ELECTRICAL SERVICE

- 2,700 amps @ 120/208 volts

PUBLIC TRANSPORTATION

- Walking distance to Sunnyvale Caltrain station
- Immediate access to Central Expressway, Highways 237 and 101



Floor Plan

330 POTRERO AVENUE, SUNNYVALE

±35,654 SF (DIVISIBLE TO ±10,000)

- CARPET TILE
OPEN CEILING W/ SUSPENDED
LIGHT FIXTURES
- CARPET TILE
ACOUSTIC CEILING TILE W/
RECESSED LIGHT FIXTURES
- SEALED CONCRETE
OPEN CEILING W/ SUSPENDED
LIGHT FIXTURES
- POLISHED CONCRETE
OPEN CEILING W/ SUSPENDED
LIGHT FIXTURES
- CERAMIC TILE
GYP BD CEILING W/ RECESSED
LIGHT FIXTURES
- NOT IN SCOPE
- LINE OF CEILING
CLOUD ABOVE
- NEW STOREFRONT SYSTEM

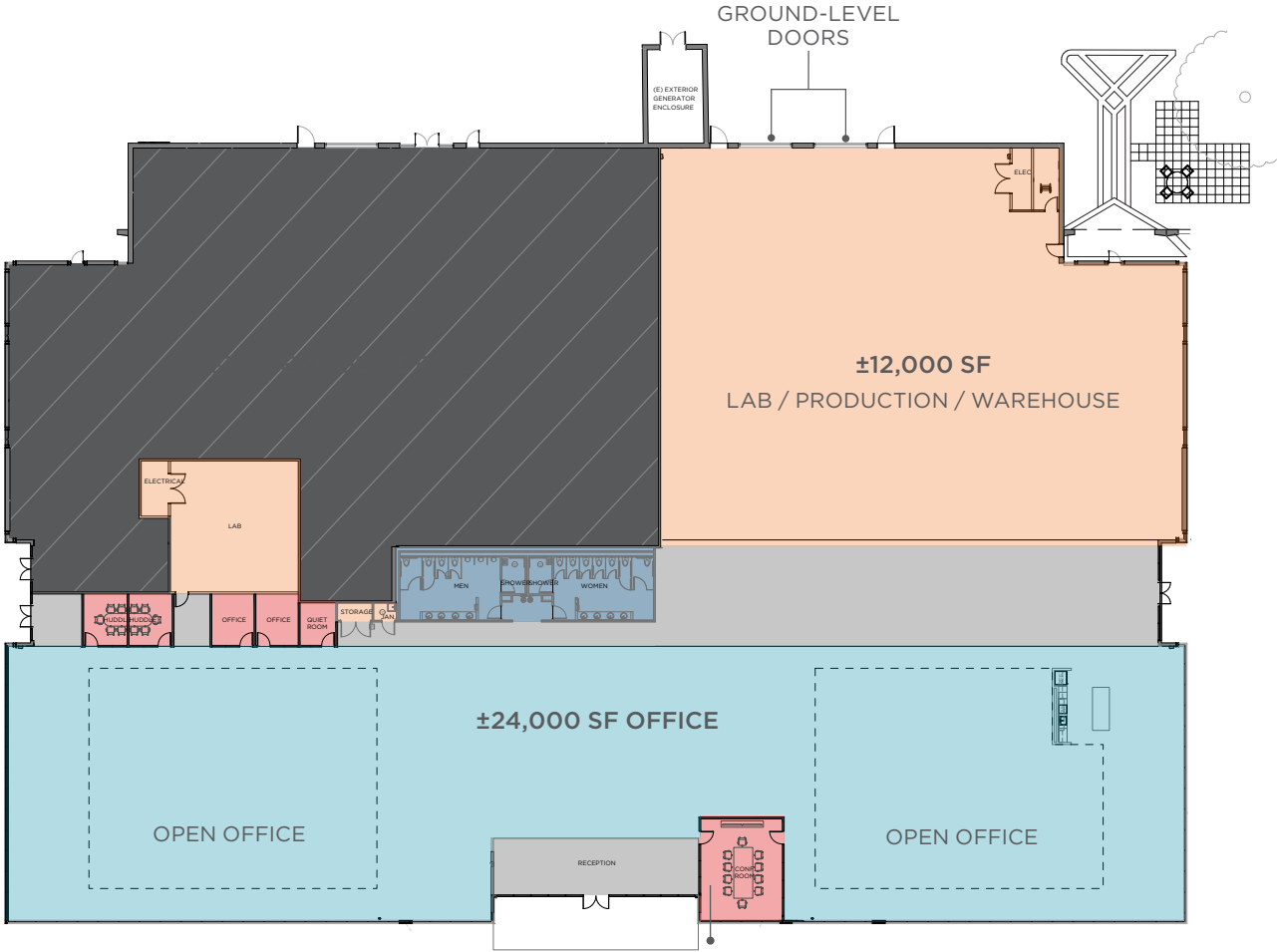

Hypothetical Layout

330 POTRERO AVENUE, SUNNYVALE

- PRIVATE OFFICES
- 6' X 6' CUBES
- BREAK AREA
- MULTI-PURPOSE ROOM
- MEETING ROOMS
- PHONE ROOMS

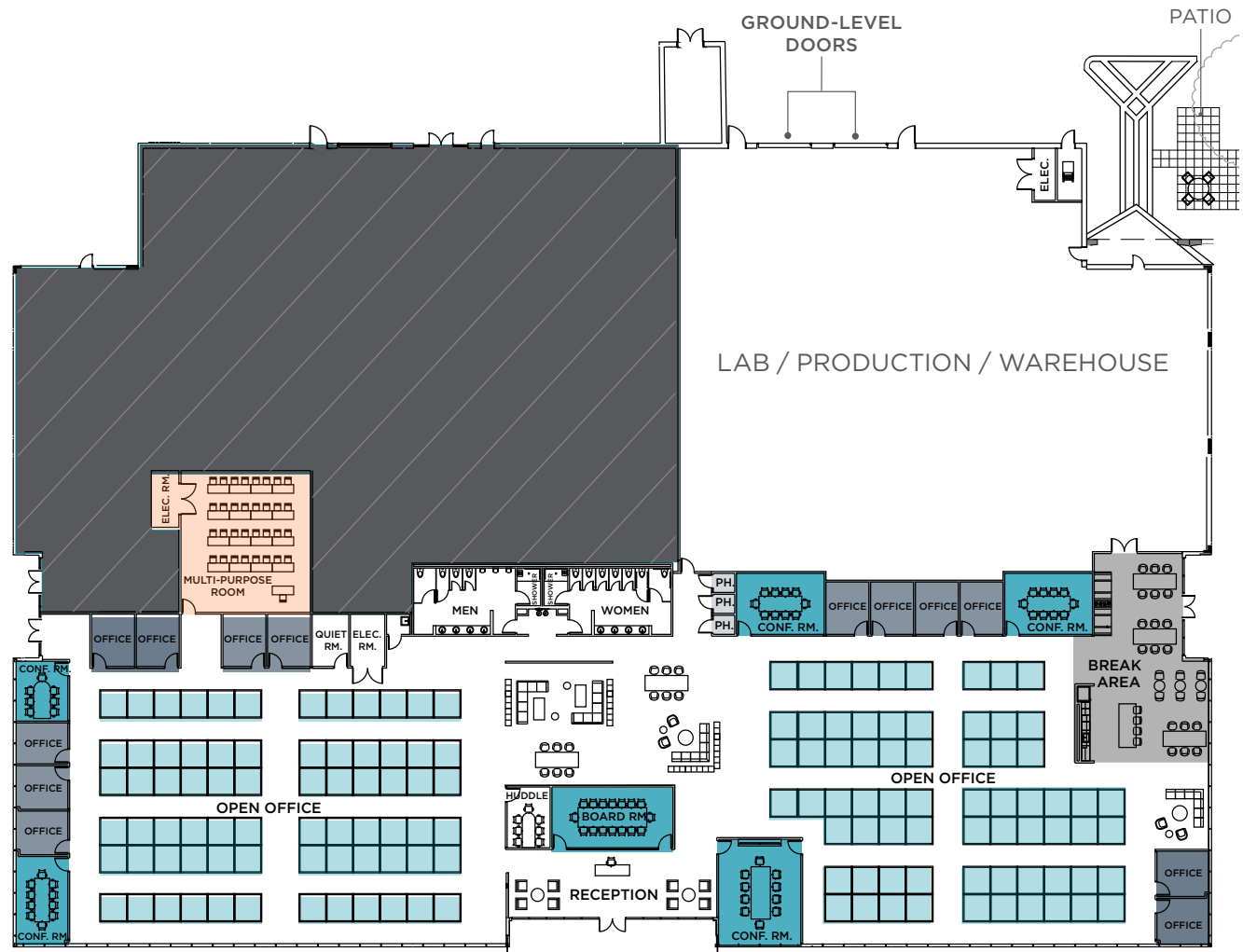

Site Plan

330 POTRERO AVENUE, SUNNYVALE

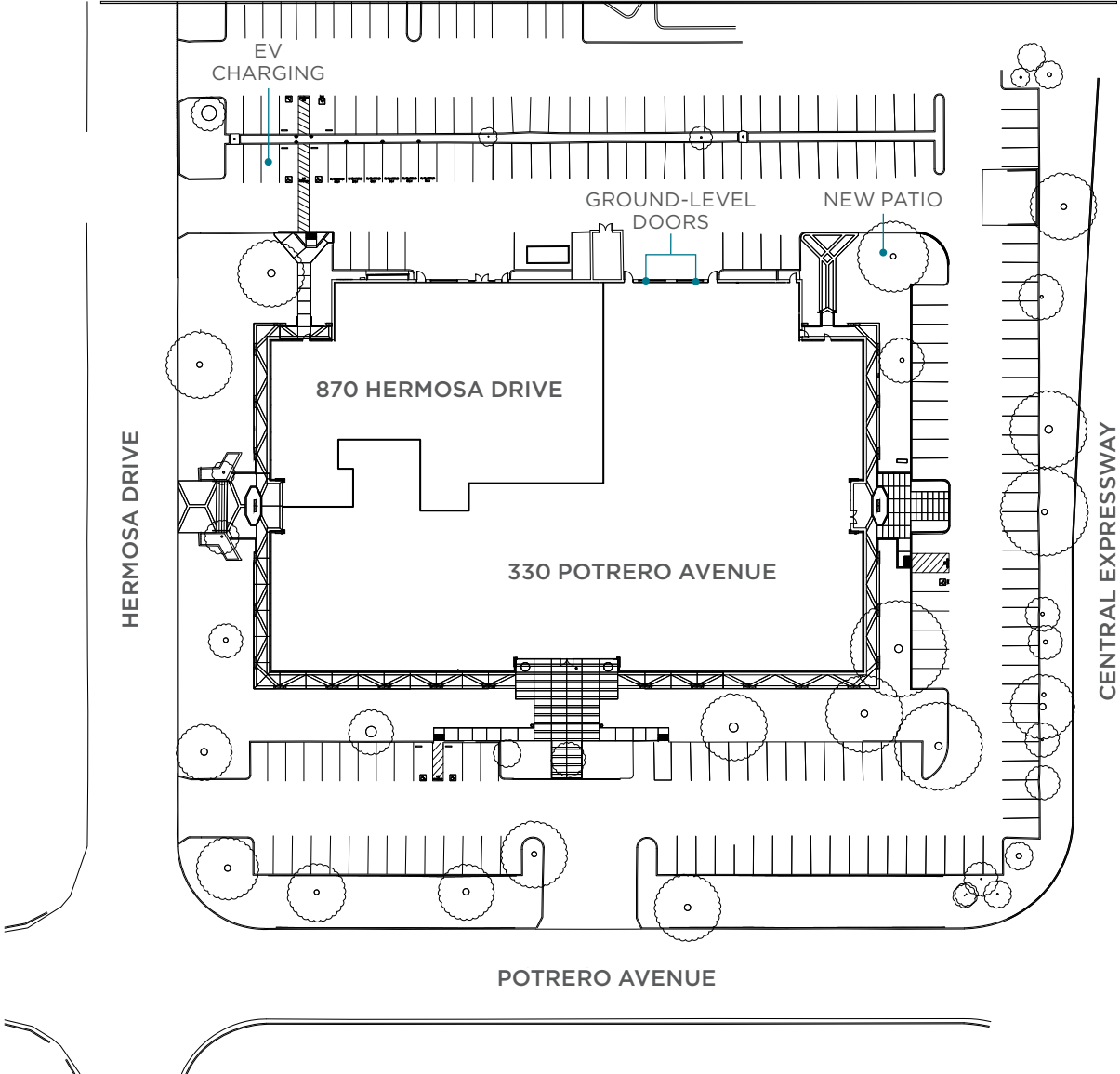

Amenities & Transit

330 POTRERO AVENUE, SUNNYVALE



330 POTRERO AVENUE



15 MIN WALK TO STATION

PHOVEVER
FLYWHEEL SPORTS
KABUL AFGHAN CUISINE

FIREHOUSE GRILL & BREWERY	VINO VINO
TAVERNA BISTRO	POKI BOWL
MEZZE TURKISH BBQ	DISH DASH
K TEA	BEAN SCENE CAFE
RIVER ROCK TAPROOM	GUMBA'S ITALIAN
CHEF YU CHINESE	BELLA ROMA
METRO CITY	SIAM TASTE THAI
CHOCOLATIER DESIREE	ROBERTO'S CANTINA
RAMEN SEAS	IL POSTALE
TAO TAO CHINESE	COFFEE & MORE
LILY'S MAC'S	
THE OXFORD	

Sunnyvale
Caltrain Station

PHILZ COFFEE
VITALITY BOWL
THE DON'S DELI
SAJJ MEDITERRANEAN

ORANGETHEORY FITNESS
STARBUCKS
NOM BURBER
TAPT
THE PROLIFIC OVEN
CITY PLACE WINE BAR
BEACH HUT DELI



OWNED AND MANAGED BY



TODD HEDRICK
REGIONAL VICE PRESIDENT
thedrick@irvinecompany.com
CA Lic. 01152266
408.330.0126

FOR LEASING



MARK SCHMIDT
VICE CHAIRMAN
mark.schmidt@cbre.com
CA Lic. 00872826
408.460.5295

WILL SCHMIDT
SENIOR VICE PRESIDENT
will.schmidt@cbre.com
CA Lic. 01988485
408.453.7408

©2025 CBRE, Inc. and Irvine Management Company. All rights reserved. This information has been obtained from sources believed reliable, but CBRE and Irvine Management Company make no representation or warranty as to the accuracy or completeness of such data and it should be independently verified by prospective tenants. You should conduct a careful, independent investigation of the property and verify all information. Any reliance on this information is solely at your own risk. All renderings, floor plans, pictures shown are for information and illustration purposes only and are subject to change. Images may not be to scale. May not show final material and finishes. Products, features, and amenities subject to availability. CBRE and the CBRE logo are service marks of CBRE, Inc. All other marks displayed on this document are the property of their respective owners, and the use of such logos does not imply any affiliation with or endorsement of CBRE. Photos herein are the property of their respective owners. Use of these images without the express written consent of the owner is prohibited. The Sunwave and Irvine Company are registered trademarks of Irvine Management Company. All properties are offered for lease through Irvine Management Company, a licensed real estate broker DRE LIC. #02041810.